

SQB Load Cell

Single Ended Beam Load Cell

- Maximum capacity (E_{max}) (t):
0.1, 0.3, 0.5, 1, 2, 3, 5, 7.5, 10

- Be suitable for the fields of Ground Scales, Platform Scales, Belt Scales, Industries of Foods, Pharmaceuticals, which has huge important on weighing and control.



Dimensions(mm)

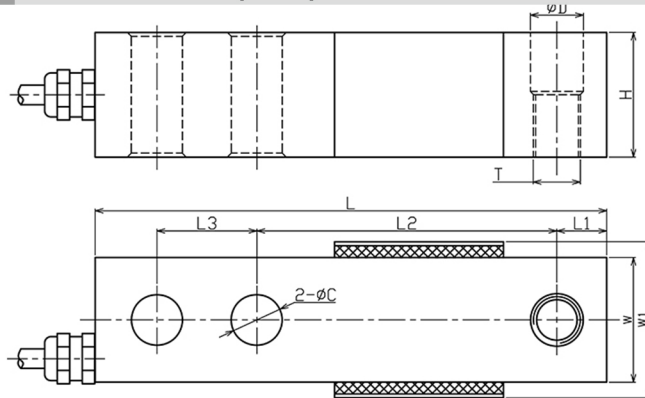

Wiring code

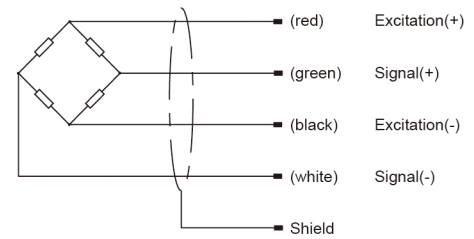

量程 Capacity(t)	L	L1	L2	L3	L4	W	W1	H	ØD	ØC	T
0.1,0.3,0.5,1,2	130	12.7	76.2	25.4	55	32	40	32	13	13.5	M12*1.75
3,5	172	19.5	95.3	38.1	75	38	46	38	19.5	20	M20*1.5

Specifications

Rated Load	t	0.1, 0.3, 0.5, 1, 2, 3, 5, 7.5, 10		
Rated Output	mV/V	2.0±0.005		
Zero Balance	%R.O.	±1		
Comprehensive Error	%R.O.	±0.02		
Creep after 30 minutes	%R.O.	±0.02		
Recommended excitation voltage	VDC	5-12 /15(max)		
Input impedance	Ω	380±10		
Output impedance	Ω	350±5		
Insulation resistance	MΩ	≥5000 (50VDC)		
Safe overload	%R.C.	150		
Ultimate overload	%R.C.	300		
Material		Alloy Steel		
Degree of protection		IP67		
The length of the cable	m	0.1t-2t: 3m	3t-5t: 5m	7.5t-10t: 6.5m
Tightening torque	N•m	0.1t-2t: 98N•m	3t-5t: 275N•m	7.5t-10t: 750N•m